

# Parkside

Nature's Neighbour

1, 2 & 3 bedrooms

The Brunswick

**Thrive**  
Homes

# Site plan



## Key

- D Disabled parking space
- CCP Car Club parking space
- EV Electric charging point





# Specification

## Kitchen

- Open-plan kitchen/living area
- Contemporary handleless Dove Grey kitchen
- Slimline 22mm light grey worktops
- 1 ½ bowl Blanco stainless steel sink with mixer tap
- Kitchen pelmet lighting
- White LED downlights
- Integrated kitchen appliances:
  - Electric oven
  - Frameless black 4 zone induction hob
  - Black glass splashback to hob
  - Cooker hood canopy
  - Fridge freezer
  - Washer dryer

## Bathroom & en-suites

- En-suites to all 2 & 3 bedroom apartments
- Modern white sanitaryware
- Single monoblock mixer tap
- Thermostatic shower mixer
  - Above bath
  - Showers
- Shower screen over bath
- Touch Light Grey Satin tile
  - Full height around bath
  - Half height around wash basin & WC
- Heated chrome towel rail
- White LED downlights

## Features

- EV car charging points (selected spaces)
- Car Club
- Air source heat pump system
- Communal gardens
- Vegetable and flower garden areas
- USB charging point socket to lounge, kitchen and bedroom
- Video door entry system
- Smoke, heat and CO detectors
- External light fitting to front door and balcony/terrace
- Cycle storage

## Finishings

- White Dulux paint throughout
- Chrome ironmongery
- Amtico Spacia Nordic Oak floor panels to all floors except bedrooms
- New Dublin Twist, Dolphin carpet to bedrooms and stairs (where applicable)





Parkside – The Brunswick

# The Brunswick – Ground floor

## Plot 025

One bedroom apartment

<b>Kitchen/Dining/Living</b>	6.50m x 4.03m	21'4" x 13'3"
<b>Bedroom</b>	4.69m x 3.19m	15'5" x 10'6"
<b>Terrace</b>	19.6m <sup>2</sup>	
<b>Total area</b>	57.5m <sup>2</sup>	

## Key

- ◄► Measurement Points
- WC Cloakroom
- S Store Cupboard
- Duplex Apartment
- Private access to primary front door entrance

## Plot 026

Two bedroom apartment

<b>Kitchen/Dining/Living</b>	6.57m x 4.51m	21'7" x 14'10"
<b>Bedroom 1</b>	5.00m x 2.87m	16'5" x 9'5"
<b>Bedroom 2</b>	3.36m x 2.50m	11'0" x 8'2"
<b>Terrace</b>	14.7m <sup>2</sup>	
<b>Total area</b>	71.2m <sup>2</sup>	

## Plot 027 & 028

Three bedroom duplex apartment (ground floor & first floor)

<b>Kitchen/Dining/Living</b>	8.41m x 5.30m	27'7" x 17'5"
<b>Terrace</b>	20.4m <sup>2</sup>	
<b>Total ground floor area</b>	61m <sup>2</sup>	

## Plot 029

Two bedroom apartment

<b>Kitchen/Dining/Living</b>	6.20m x 4.47m	20'4" x 14'8"
<b>Bedroom 1</b>	4.83m x 2.95m	15'10" x 9'8"
<b>Bedroom 2</b>	4.60m x 2.98m	15'1" x 9'9"
<b>Terrace</b>	23.1m <sup>2</sup>	
<b>Total area</b>	77.2m <sup>2</sup>	

## Plot 030

One bedroom apartment

<b>Kitchen/Dining/Living</b>	6.56m x 4.33m	21'6" x 14'2"
<b>Bedroom 1</b>	4.35m x 3.40m	14'3" x 11'2"
<b>Terrace</b>	14.6m <sup>2</sup>	
<b>Total area</b>	51.8m <sup>2</sup>	

Total floor area may vary slightly to the figure that is listed. The dimensions shown are accurate to within +/- 50mm, they are not intended to be used for carpet sizes, appliances, spaces or items of furniture. Wardrobes are included in the master bedroom only, all other furniture is indicative and not supplied. Map is not to scale. Subject to change. September 2023.

# The Brunswick – Ground floor

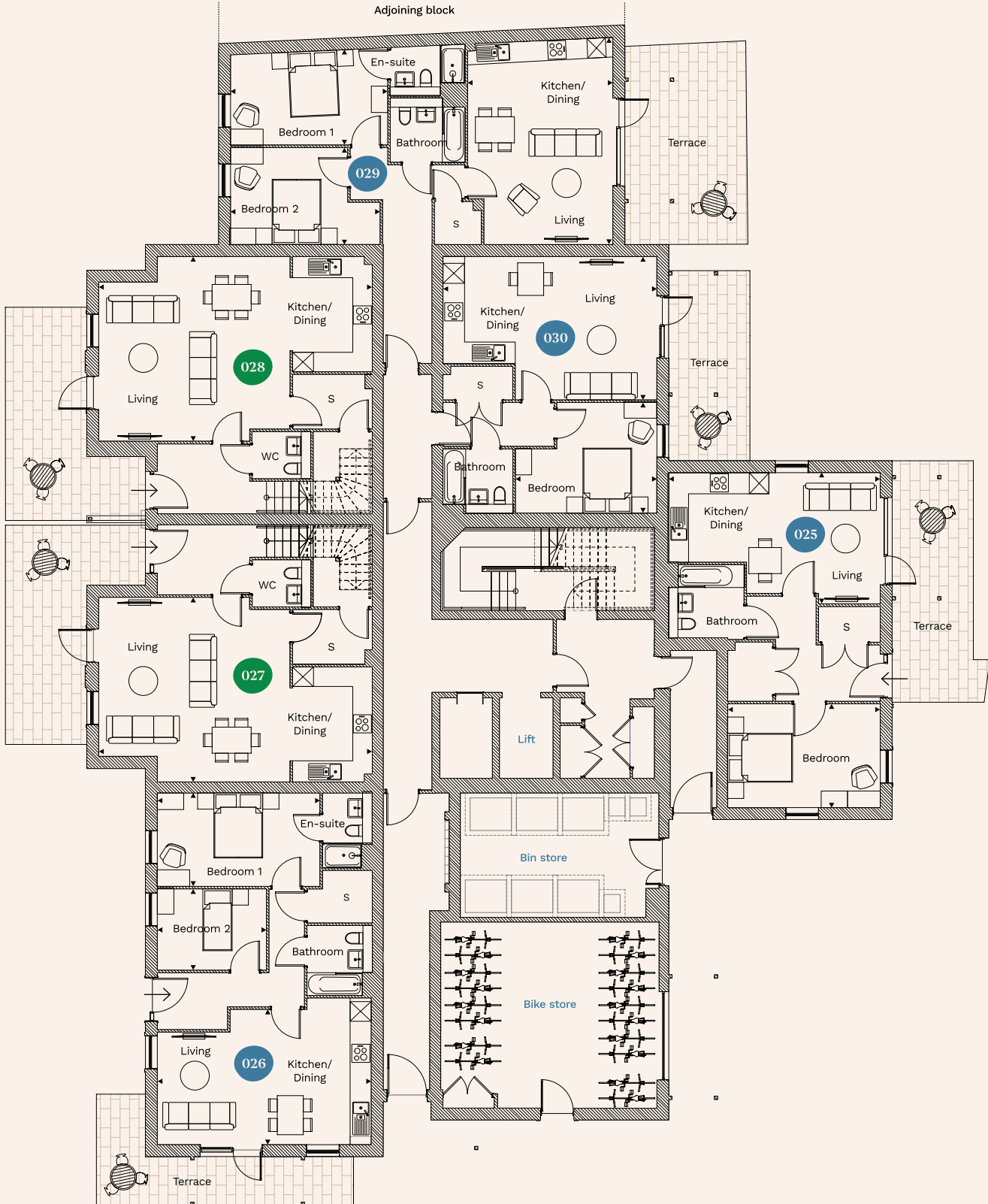

# The Brunswick – First floor

## Plot 027 & 028

Three bedroom duplex apartment (ground floor & first floor)

<b>Bedroom 1</b>	6.43m x 2.81m	21'1" x 9'3"
<b>Bedroom 2</b>	5.16m x 2.79m	16'11" x 9'2"
<b>Bedroom 3</b>	5.53m x 2.15m	18'2" x 7'1"
<b>Terrace</b>	20.4m <sup>2</sup>	
<b>Total first floor area</b>	<b>57.2m<sup>2</sup></b>	

## Key

- ◀▶ Measurement Points
- WC Cloakroom
- S Store Cupboard
- Duplex Apartment

## Plot 031

Two bedroom apartment

<b>Kitchen/Dining/Living</b>	6.60m x 5.27m	21'8" x 17'3"
<b>Bedroom 1</b>	4.35m x 3.00m	14'3" x 9'10"
<b>Bedroom 2</b>	4.39m x 3.06m	14'5" x 10'0"
<b>Balcony</b>	5.7m <sup>2</sup>	
<b>Total area</b>	<b>70.7m<sup>2</sup></b>	

## Plot 032

Two bedroom apartment

<b>Kitchen/Dining/Living</b>	6.57m x 4.21m	21'7" x 13'10"
<b>Bedroom 1</b>	5.00m x 2.87m	16'5" x 9'5"
<b>Bedroom 2</b>	3.58m x 3.46m	11'9" x 11'4"
<b>Balcony</b>	5.2m <sup>2</sup>	
<b>Total area</b>	<b>71.2m<sup>2</sup></b>	

## Plot 033

Two bedroom apartment

<b>Kitchen/Dining/Living</b>	6.20m x 4.47m	20'4" x 14'8"
<b>Bedroom 1</b>	4.83m x 3.00m	15'10" x 9'10"
<b>Bedroom 2</b>	4.60m x 2.98m	15'1" x 9'9"
<b>Balcony</b>	5.7m <sup>2</sup>	
<b>Total area</b>	<b>71.7m<sup>2</sup></b>	

## Plot 034

One bedroom apartment

<b>Kitchen/Dining/Living</b>	6.56m x 4.33m	21'6" x 14'2"
<b>Bedroom 1</b>	4.35m x 3.40m	14'3" x 11'2"
<b>Balcony</b>	5.7m <sup>2</sup>	
<b>Total area</b>	<b>51.8m<sup>2</sup></b>	

## Plot 035

Two bedroom apartment

<b>Kitchen/Dining/Living</b>	6.50m x 3.70m	21'4" x 12'2"
<b>Bedroom 1</b>	4.27m x 3.08m	14'0" x 10'1"
<b>Bedroom 2</b>	3.24m x 3.35m	10'8" x 10'12"
<b>Balcony</b>	5.7m <sup>2</sup>	
<b>Total area</b>	<b>66.8m<sup>2</sup></b>	

Total floor area may vary slightly to the figure that is listed. The dimensions shown are accurate to within +/- 50mm, they are not intended to be used for carpet sizes, appliances, spaces or items of furniture. Wardrobes are included in the master bedroom only, all other furniture is indicative and not supplied. Map is not to scale. Subject to change. September 2023.



# The Brunswick – First floor

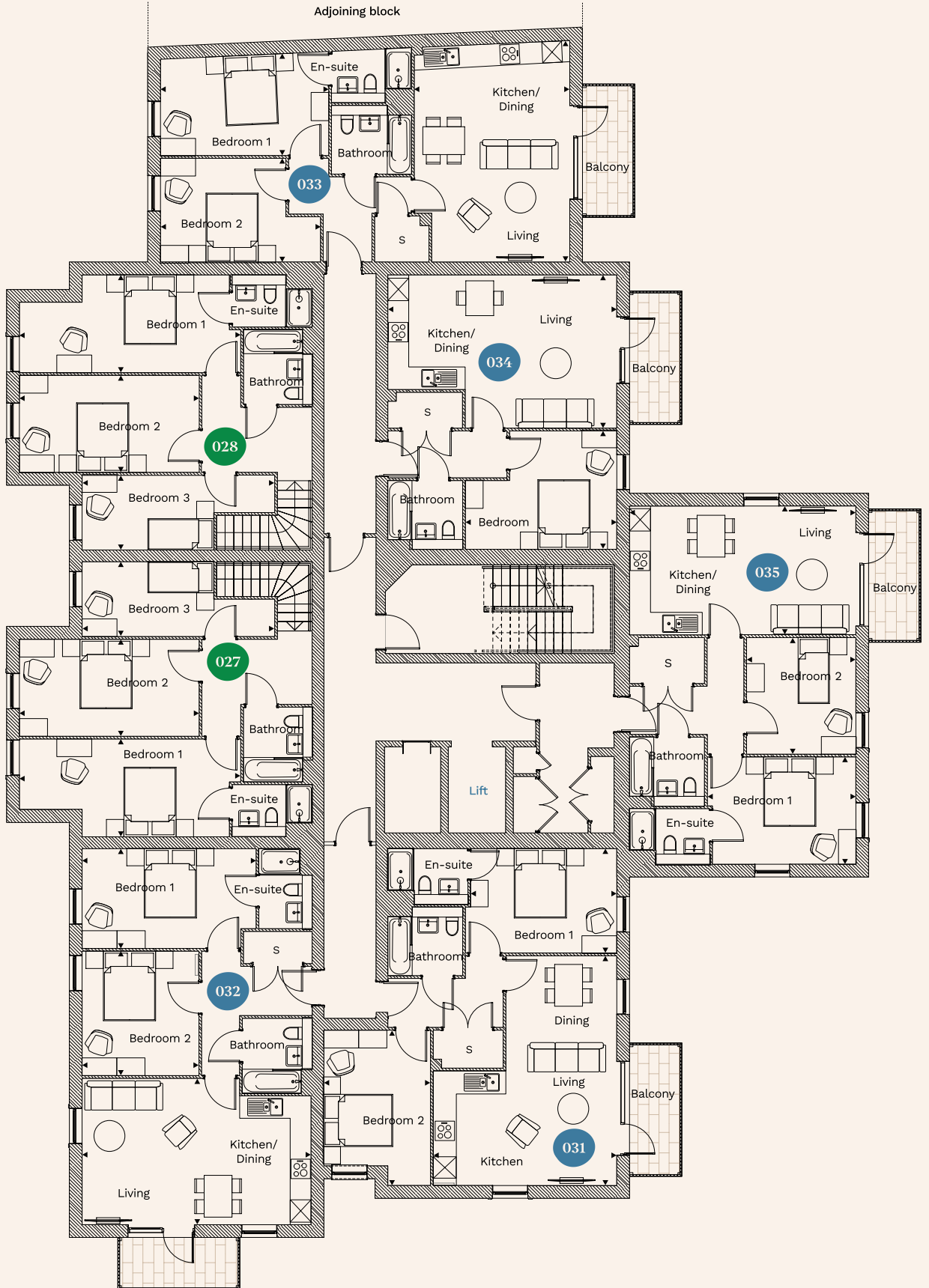

# The Brunswick – Second floor

## Plot 036

Two bedroom apartment

<b>Kitchen/Dining/Living</b>	6.60m x 5.27m	21'8" x 17'3"
<b>Bedroom 1</b>	4.35m x 3.00m	14'3" x 9'10"
<b>Bedroom 2</b>	4.39m x 3.06m	14'5" x 10'0"
<b>Balcony</b>	5.7m <sup>2</sup>	
<b>Total area</b>	<b>71m<sup>2</sup></b>	

## Key

- ◀▶ Measurement Points
- WC Cloakroom
- S Store Cupboard

## Plot 037

Two bedroom apartment

<b>Kitchen/Dining/Living</b>	6.57m x 4.21m	21'7" x 13'10"
<b>Bedroom 1</b>	5.00m x 2.87m	16'5" x 9'5"
<b>Bedroom 2</b>	3.58m x 3.46m	11'9" x 11'4"
<b>Balcony</b>	5.2m <sup>2</sup>	
<b>Total area</b>	<b>71.2m<sup>2</sup></b>	

## Plot 038

One bedroom apartment

<b>Kitchen/Dining/Living</b>	6.61m x 4.41m	21'8" x 14'6"
<b>Bedroom</b>	4.33m x 3.42m	14'2" x 11'3"
<b>Balcony</b>	7.2m <sup>2</sup>	
<b>Total area</b>	<b>52.1m<sup>2</sup></b>	

## Plot 039

One bedroom apartment

<b>Kitchen/Dining/Living</b>	6.61m x 4.41m	21'8" x 14'6"
<b>Bedroom</b>	4.33m x 3.42m	14'2" x 11'3"
<b>Balcony</b>	7.2m <sup>2</sup>	
<b>Total area</b>	<b>52.1m<sup>2</sup></b>	

## Plot 040

Two bedroom apartment

<b>Kitchen/Dining/Living</b>	6.20m x 4.47m	20'4" x 14'8"
<b>Bedroom 1</b>	4.83m x 3.00m	15'10" x 9'10"
<b>Bedroom 2</b>	4.60m x 2.98m	15'1" x 9'9"
<b>Balcony</b>	5.7m <sup>2</sup>	
<b>Total area</b>	<b>71.7m<sup>2</sup></b>	

## Plot 041

One bedroom apartment

<b>Kitchen/Dining/Living</b>	6.56m x 4.33m	21'6" x 14'2"
<b>Bedroom</b>	4.35m x 3.40m	14'3" x 11'2"
<b>Balcony</b>	5.7m <sup>2</sup>	
<b>Total area</b>	<b>51.8m<sup>2</sup></b>	

## Plot 042

Two bedroom apartment

<b>Kitchen/Dining/Living</b>	6.50m x 3.70m	21'4" x 12'2"
<b>Bedroom 1</b>	4.27m x 3.08m	14'0" x 10'1"
<b>Bedroom 2</b>	3.24m x 3.35m	10'8" x 10'12"
<b>Balcony</b>	5.7m <sup>2</sup>	
<b>Total area</b>	<b>66.8m<sup>2</sup></b>	

Total floor area may vary slightly to the figure that is listed. The dimensions shown are accurate to within +/- 50mm, they are not intended to be used for carpet sizes, appliances, spaces or items of furniture. Wardrobes are included in the master bedroom only, all other furniture is indicative and not supplied. Map is not to scale. Subject to change. September 2023.

# The Brunswick – Second floor

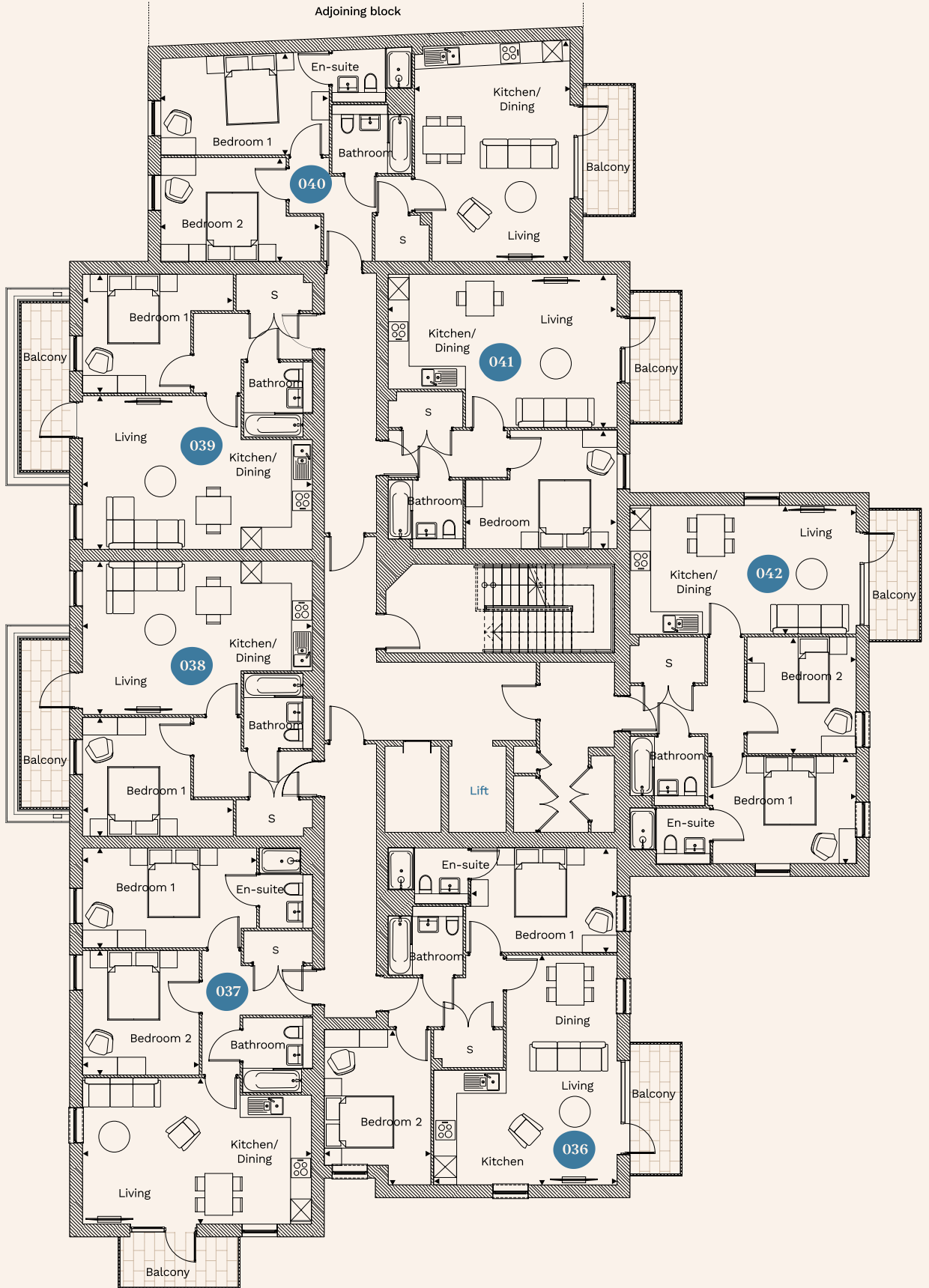

# The Brunswick – Third floor

## Plot 043

Two bedroom apartment

<b>Kitchen/Dining/Living</b>	7.76m x 3.66m	25'6" x 12'0"
<b>Bedroom 1</b>	4.59m x 2.75m	15'1" x 9'0"
<b>Bedroom 2</b>	4.59m x 2.12m	15'1" x 6'11"
<b>Balcony</b>	12.3m <sup>2</sup>	
<b>Total area</b>	<b>65.2m<sup>2</sup></b>	

## Key

- ◀▶ Measurement Points
- WC Cloakroom
- S Store Cupboard

## Plot 044

Two bedroom apartment

<b>Kitchen/Dining/Living</b>	8.56m x 4.77m	28'1" x 15'8"
<b>Bedroom 1</b>	5.82m x 3.23m	19'1" x 10'7"
<b>Bedroom 2</b>	4.75m x 4.56m	15'7" x 14'12"
<b>Balcony 1</b>	11.9m <sup>2</sup>	
<b>Balcony 2</b>	10.2m <sup>2</sup>	
<b>Total area</b>	<b>84.8m<sup>2</sup></b>	

## Plot 045

One bedroom apartment

<b>Kitchen/Dining/Living</b>	6.34m x 4.81m	20'10" x 15'9"
<b>Bedroom 1</b>	4.56m x 3.31m	15'0" x 10'10"
<b>Balcony</b>	8.9m <sup>2</sup>	
<b>Total area</b>	<b>52.7m<sup>2</sup></b>	

## Plot 046

Two bedroom apartment

<b>Kitchen/Dining/Living</b>	6.20m x 4.47m	20'4" x 14'8"
<b>Balcony 1</b>	4.83m x 3.00m	15'10" x 9'10"
<b>Balcony 2</b>	4.60m x 2.98m	15'1" x 9'9"
<b>Terrace</b>	5.7m <sup>2</sup>	
<b>Total area</b>	<b>71.7m<sup>2</sup></b>	

## Plot 047

One bedroom apartment

<b>Kitchen/Dining/Living</b>	6.56m x 4.33m	21'6" x 14'2"
<b>Bedroom 1</b>	4.35m x 3.40m	14'3" x 11'2"
<b>Balcony</b>	5.7m <sup>2</sup>	
<b>Total area</b>	<b>51.8m<sup>2</sup></b>	

Total floor area may vary slightly to the figure that is listed. The dimensions shown are accurate to within +/- 50mm, they are not intended to be used for carpet sizes, appliances, spaces or items of furniture. Wardrobes are included in the master bedroom only, all other furniture is indicative and not supplied. Map is not to scale. Subject to change. September 2023.

# The Brunswick – Third floor

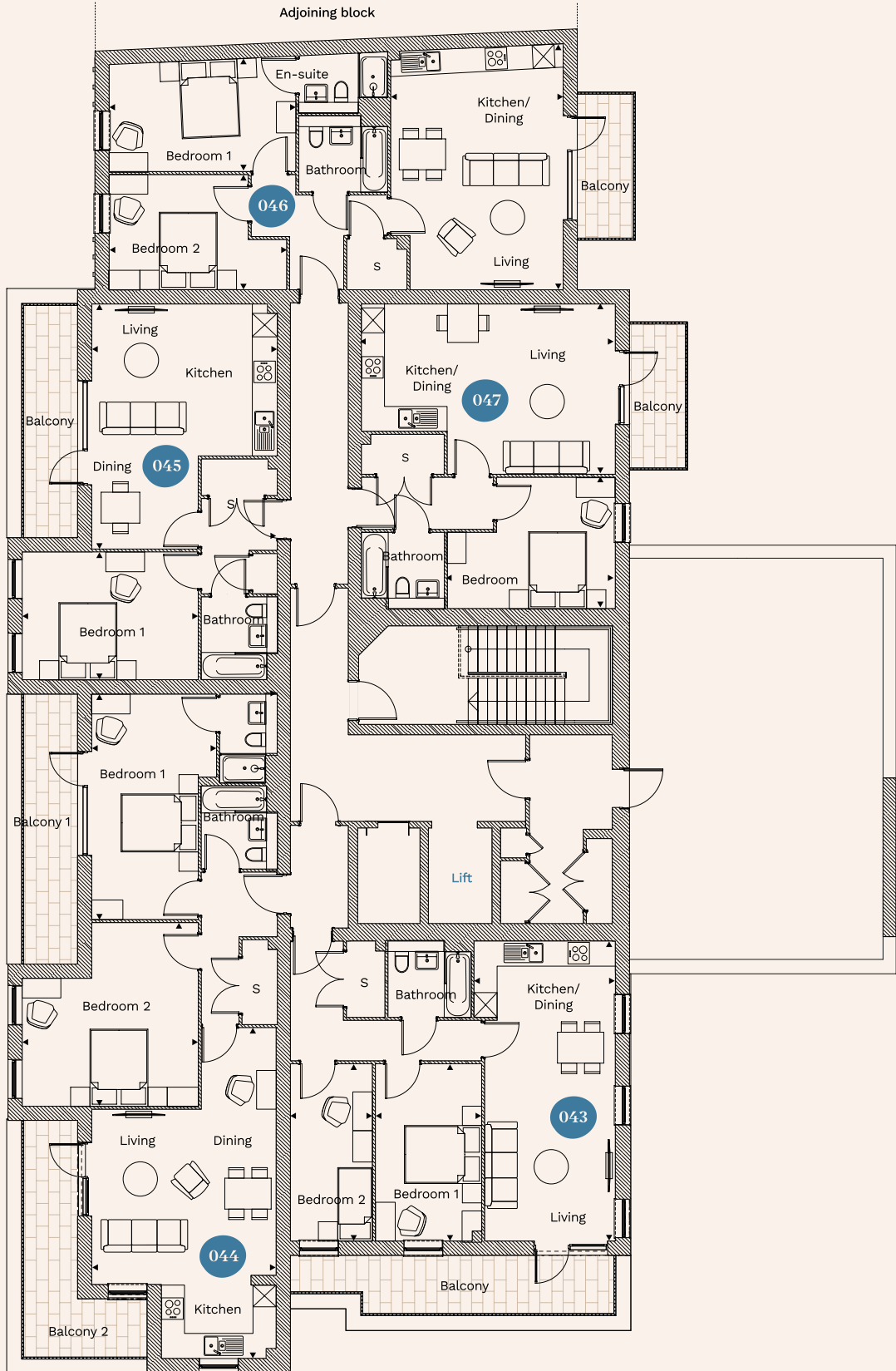

# Parkside

Nature's Neighbour

[parksidewatford.co.uk](http://parksidewatford.co.uk)