

Parkside

Nature's Neighbour

1, 2 & 3 bedrooms

Arden Place

Thrive
Homes

Site plan



Key

- D Disabled parking space
- CCP Car Club parking space
- EV Electric charging point





Specification

Kitchen

- Open-plan kitchen/living area
- Contemporary handleless Dove Grey kitchen
- Slimline 22mm light grey worktops
- 1 ½ bowl Blanco stainless steel sink with mixer tap
- Kitchen pelmet lighting
- White LED downlights
- Integrated kitchen appliances:
 - Electric oven
 - Frameless black 4 zone induction hob
 - Black glass splashback to hob
 - Cooker hood canopy
 - Fridge freezer
 - Washer dryer

Bathroom & en-suites

- En-suites to all 2 & 3 bedroom apartments
- Modern white sanitaryware
- Single monoblock mixer tap
- Thermostatic shower mixer
 - Above bath
 - Showers
- Shower screen over bath
- Touch Light Grey Satin tile
 - Full height around bath
 - Half height around wash basin & WC
- Heated chrome towel rail
- White LED downlights

Features

- EV car charging points (selected spaces)
- Car Club
- Air source heat pump system
- Communal gardens
- Vegetable and flower garden areas
- USB charging point socket to lounge, kitchen and bedroom
- Video door entry system
- Smoke, heat and CO detectors
- External light fitting to front door and balcony/terrace
- Cycle storage

Finishings

- White Dulux paint throughout
- Chrome ironmongery
- Amtico Spacia Nordic Oak floor panels to all floors except bedrooms
- New Dublin Twist, Dolphin carpet to bedrooms and stairs (where applicable)

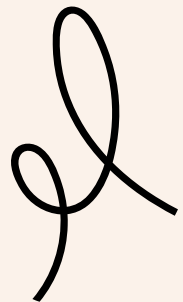



Arden House – Ground floor

Plot 001

One bedroom apartment

Kitchen/Dining/Living	6.50m x 4.03m	21'4" x 13'3"
Bedroom	4.69m x 3.19m	15'5" x 10'6"
Terrace	19.6m ²	
Total area	58m²	

Plot 002

One bedroom apartment

Kitchen/Dining/Living	6.56m x 4.33m	21'6" x 14'2"
Bedroom	4.35m x 3.40m	14'3" x 11'2"
Terrace	14.6m ²	
Total area	52m²	

Plot 003

Two bedroom apartment

Kitchen/Dining/Living	6.20m x 4.47m	20'4" x 14'8"
Bedroom 1	4.83m x 2.95m	15'10" x 9'8"
Bedroom 2	4.60m x 2.98m	15'1" x 9'9"
Terrace	22.9m ²	
Total area	77m²	

Plot 004 & 005

Three bedroom duplex apartment (ground floor & first floor)

Kitchen/Dining/Living	8.41m x 5.30m	27'7" x 17'5"
Terrace	20.4m ²	
Total ground floor area	61m²	

Plot 006

Two bedroom apartment

Kitchen/Dining/Living	6.57m x 4.51m	21'7" x 14'10"
Bedroom 1	5.00m x 2.87m	16'5" x 9'5"
Bedroom 2	3.36m x 2.50m	11'0" x 8'2"
Terrace	14.7m ²	
Total area	71m²	

Key

- ◀▶ Measurement Points
- WC Cloakroom
- S Store Cupboard
- Duplex Apartment
- Private access to primary front door entrance

Total floor area may vary slightly to the figure that is listed. The dimensions shown are accurate to within +/- 50mm, they are not intended to be used for carpet sizes, appliances, spaces or items of furniture. Wardrobes are included in the master bedroom only, all other furniture is indicative and not supplied. Map is not to scale. Subject to change. September 2023.

Arden House – Ground floor

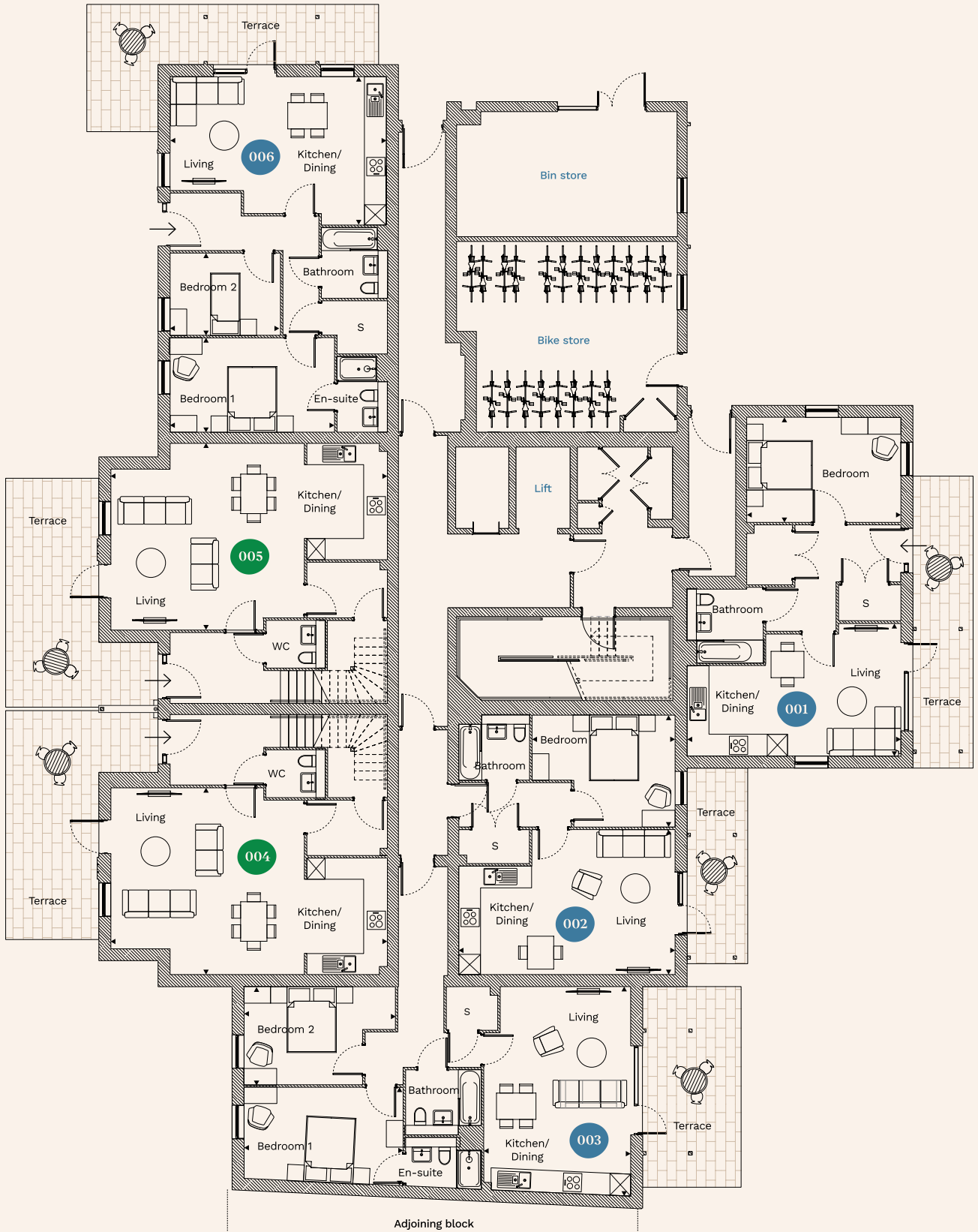

Adjoining block

Arden House – First floor

Plot 004 & 005

Three bedroom duplex apartment (ground floor & first floor)

Bedroom 1	6.43m x 2.81m	21'1" x 9'3"
Bedroom 2	5.16m x 2.79m	16'11" x 9'2"
Bedroom 3	5.53m x 2.15m	18'2" x 7'1"
Total first floor area	57m²	

Key

- ◀▶ Measurement Points
- WC Cloakroom
- S Store Cupboard
- Duplex Apartment

Plot 007

Two bedroom apartment

Kitchen/Dining/Living	6.60m x 5.27m	21'8" x 17'3"
Bedroom 1	4.35m x 3.00m	14'3" x 9'10"
Bedroom 2	4.39m x 3.06m	14'5" x 10'0"
Balcony	5.7m ²	
Total area	71m²	

Plot 008

Two bedroom apartment

Kitchen/Dining/Living	6.50m x 3.70m	21'4" x 12'2"
Bedroom 1	4.27m x 3.08m	14'0" x 10'1"
Bedroom 2	3.24m x 3.35m	10'8" x 10'12"
Balcony	5.7m ²	
Total area	67m²	

Plot 009

One bedroom apartment

Kitchen/Dining/Living	6.56m x 4.33m	21'6" x 14'2"
Bedroom	4.35m x 3.40m	14'3" x 11'2"
Balcony	5.7m ²	
Total area	52m²	

Plot 010

Two bedroom apartment

Kitchen/Dining/Living	6.20m x 4.47m	20'4" x 14'8"
Bedroom 1	4.83m x 3.00m	15'10" x 9'10"
Bedroom 2	4.60m x 2.98m	15'1" x 9'9"
Balcony	5.7m ²	
Total area	72m²	

Plot 011

Two bedroom apartment

Kitchen/Dining/Living	6.57m x 4.21m	21'7" x 13'10"
Bedroom 1	5.00m x 2.87m	16'5" x 9'5"
Bedroom 2	3.58m x 3.46m	11'9" x 11'4"
Balcony	5.2m ²	
Total area	71m²	

Total floor area may vary slightly to the figure that is listed. The dimensions shown are accurate to within +/- 50mm, they are not intended to be used for carpet sizes, appliances, spaces or items of furniture. Wardrobes are included in the master bedroom only, all other furniture is indicative and not supplied. Map is not to scale. Subject to change. September 2023.

Arden House – First floor

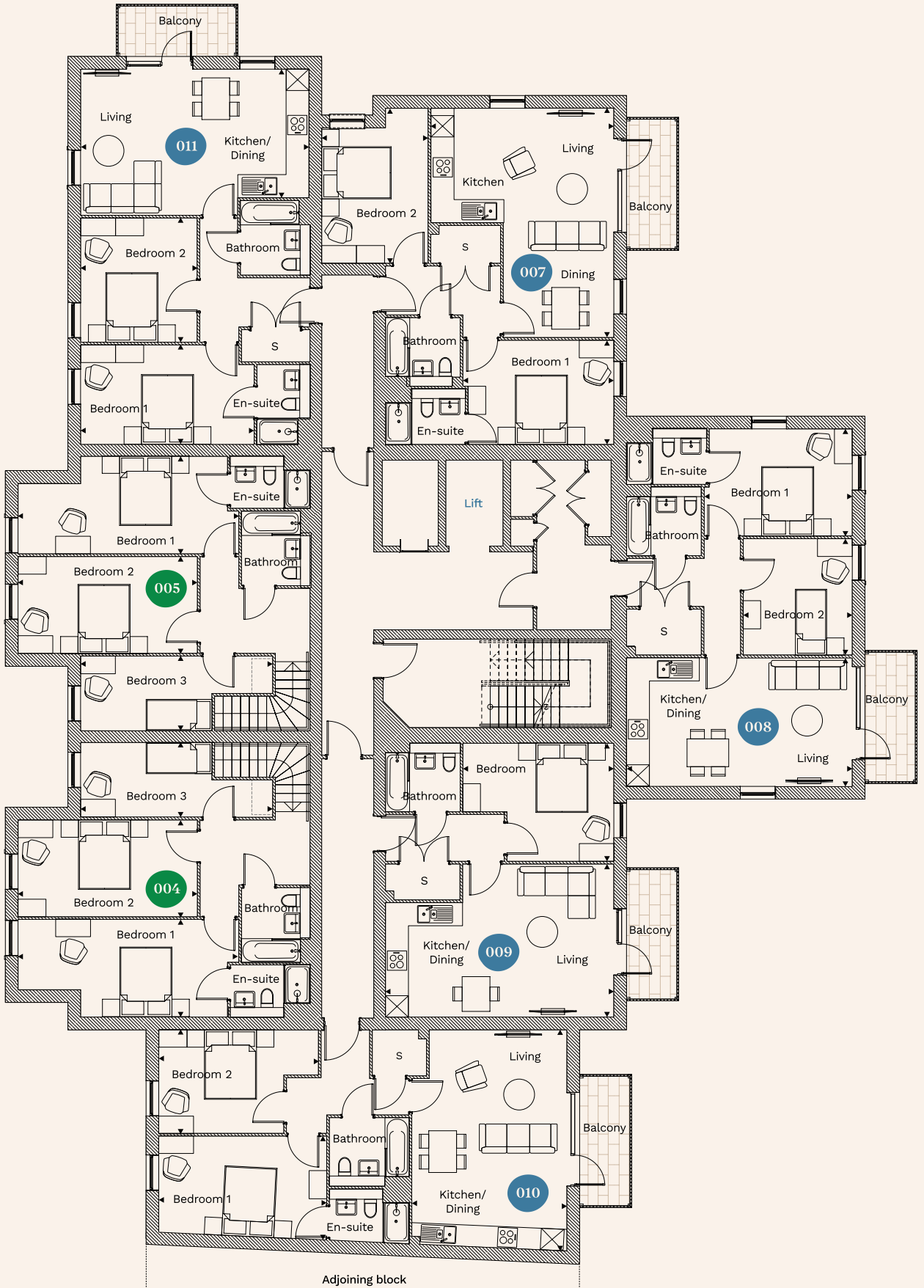

Arden House – Second floor

Plot 012

Two bedroom apartment

Kitchen/Dining/Living	6.60m x 5.27m	21'8" x 17'3"
Bedroom 1	4.35m x 3.00m	14'3" x 9'10"
Bedroom 2	4.39m x 3.06m	14'5" x 10'0"
Balcony	5.7m ²	
Total area	71m ²	

Key

- ◀▶ Measurement Points
- WC Cloakroom
- S Store Cupboard

Plot 013

Two bedroom apartment

Kitchen/Dining/Living	6.50m x 3.70m	21'4" x 12'2"
Bedroom 1	4.27m x 3.08m	14'0" x 10'1"
Bedroom 2	3.24m x 3.35m	10'8" x 10'12"
Balcony	5.7m ²	
Total area	67m ²	

Plot 014

One bedroom apartment

Kitchen/Dining/Living	6.56m x 4.33m	21'6" x 14'2"
Bedroom	4.35m x 3.40m	14'3" x 11'2"
Balcony	5.7m ²	
Total area	52m ²	

Plot 015

Two bedroom apartment

Kitchen/Dining/Living	6.20m x 4.47m	20'4" x 14'8"
Bedroom 1	4.83m x 3.00m	15'10" x 9'10"
Bedroom 2	4.60m x 2.98m	15'1" x 9'9"
Balcony	5.7m ²	
Total area	72m ²	

Plot 016 & 017

One bedroom apartment

Kitchen/Dining/Living	6.61m x 4.41m	21'8" x 14'6"
Bedroom 1	4.33m x 3.42m	14'2" x 11'3"
Balcony	7.2m ²	
Total area	52m ²	

Plot 018

Two bedroom apartment

Living room	6.57m x 4.21m	21'7" x 13'10"
Bedroom 1	5.00m x 2.87m	16'5" x 9'5"
Bedroom 2	3.58m x 3.46m	11'9" x 11'4"
Balcony	5.2m ²	
Total area	71m ²	

Total floor area may vary slightly to the figure that is listed. The dimensions shown are accurate to within +/- 50mm, they are not intended to be used for carpet sizes, appliances, spaces or items of furniture. Wardrobes are included in the master bedroom only, all other furniture is indicative and not supplied. Map is not to scale. Subject to change. September 2023.

Arden House – Second floor

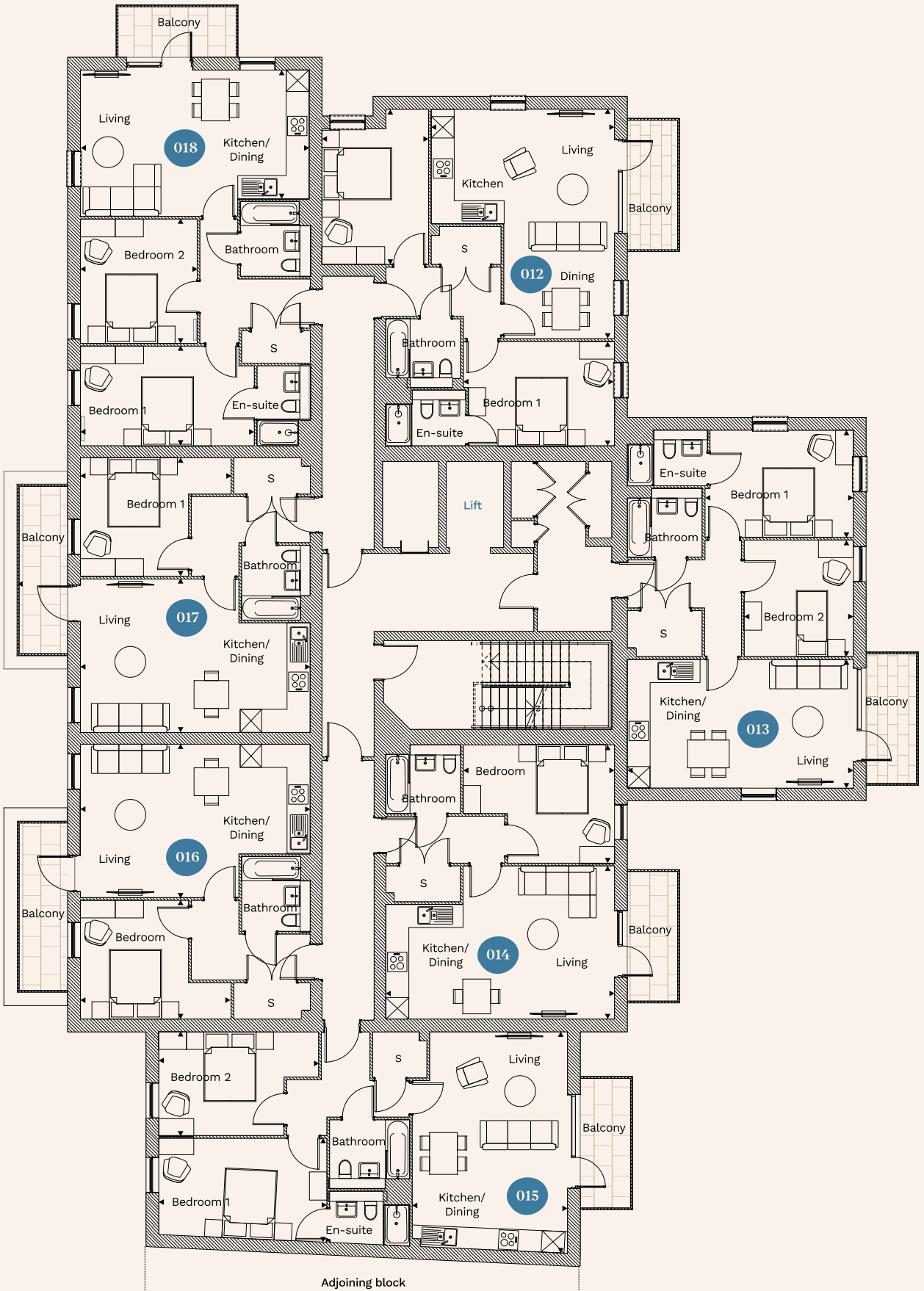

Adjoining block

Arden House – Third floor

Plot 019

Two bedroom apartment

Kitchen/Dining/Living	6.50m x 3.70m	21'4" x 12'2"
Bedroom 1	4.27m x 3.08m	14'0" x 10'1"
Bedroom 2	3.35m x 3.14m	10'12" x 10'4"
Balcony	5.7m ²	
Total area	65m ²	

Key

- ◀▶ Measurement Points
- WC Cloakroom
- S Store Cupboard

Plot 020

One bedroom apartment

Kitchen/Dining/Living	6.56m x 4.33m	21'6" x 14'2"
Bedroom	4.35m x 3.40m	14'3" x 11'2"
Balcony	5.7m ²	
Total area	52m ²	

Plot 021

Two bedroom apartment

Kitchen/Dining/Living	6.20m x 4.47m	20'4" x 14'8"
Bedroom 1	4.83m x 3.00m	15'10" x 9'10"
Bedroom 2	4.60m x 2.98m	15'1" x 9'9"
Balcony	5.7m ²	
Total area	72m ²	

Plot 022

One bedroom apartment

Kitchen/Dining/Living	6.34m x 4.81m	20'10" x 15'9"
Bedroom	4.56m x 3.31m	15'0" x 10'10"
Balcony	8.9m ²	
Total area	53m ²	

Plot 023

Two bedroom apartment

Kitchen/Dining/Living	8.56m x 4.77m	28'1" x 15'8"
Bedroom 1	5.82m x 3.23m	19'1" x 10'7"
Bedroom 2	4.75m x 4.56m	15'7" x 14'12"
Balcony 1	11.9m ²	
Balcony 2	10.2m ²	
Total area	85m ²	

Plot 024

Two bedroom apartment

Kitchen/Dining/Living	7.76m x 3.66m	25'6" x 12'0"
Bedroom 1	4.59m x 2.75m	15'1" x 9'0"
Bedroom 2	4.59m x 2.12m	15'1" x 6'11"
Balcony	12.3m ²	
Total area	65m ²	

Total floor area may vary slightly to the figure that is listed. The dimensions shown are accurate to within +/- 50mm, they are not intended to be used for carpet sizes, appliances, spaces or items of furniture. Wardrobes are included in the master bedroom only, all other furniture is indicative and not supplied. Map is not to scale. Subject to change. September 2023.

Arden House – Third floor

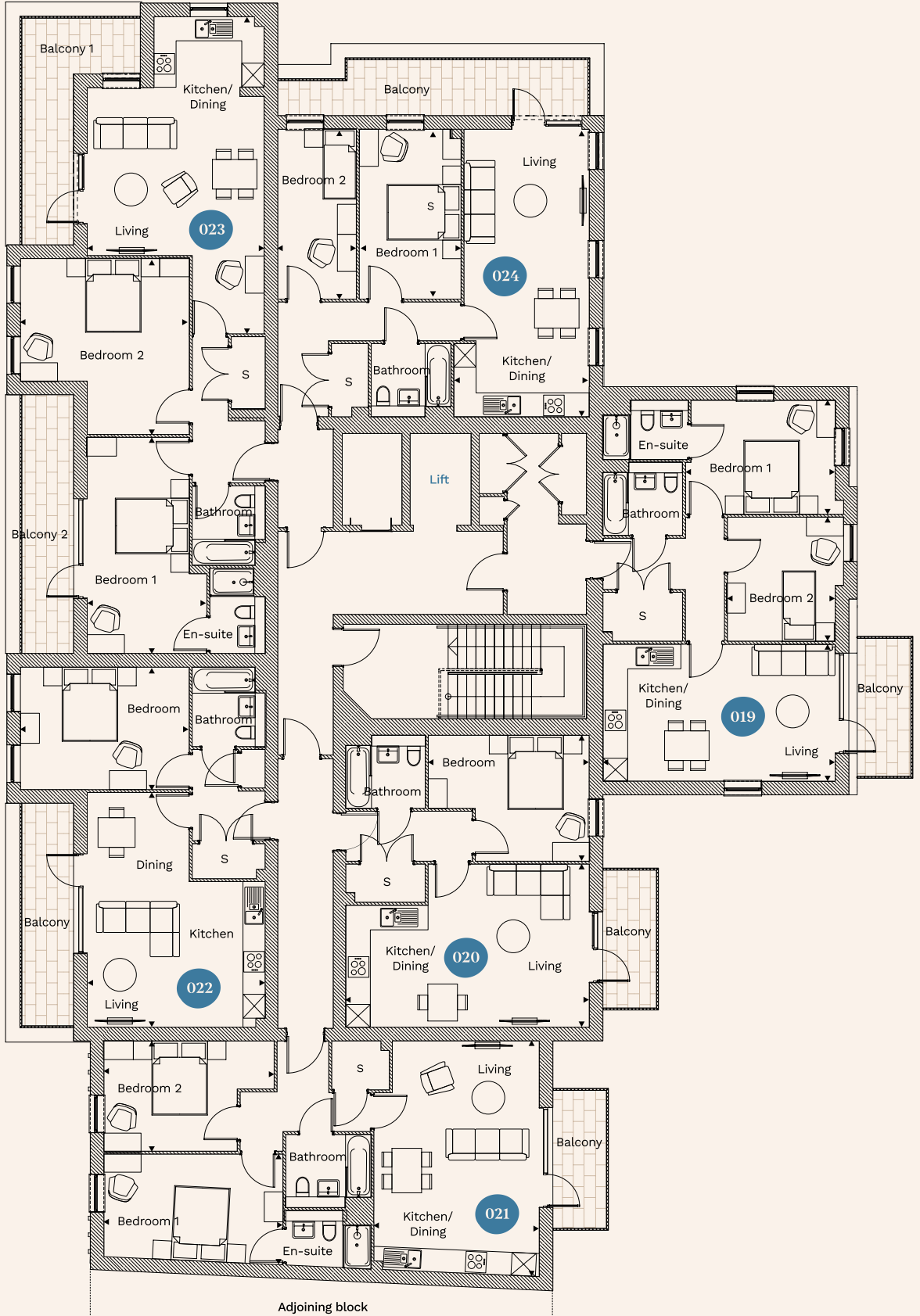

Parkside

Nature's Neighbour

parksidewatford.co.uk